



Instinct Guides You



Weston Road, Portland, Dorset DT5 2BZ £675 PCM

- Two Bedrooms
- Ground Floor
- Modern Kitchen/ Bathroom
- Allocated Parking
- Close To Amenities
- Weston, Portland
- Pets Considered
- EPC: C
- Large Lounge
- Gas Central Heating



Registration No. 08079158 Directors /Mr Wilson, Mr Tominey

Courtesy Notice Upon using WilsonTominey as selling agents ensure we are made aware of contractual obligations you may be under. We can then proceed accordingly.

WilsonTominey Ltd
15 Westham Rd.
DT4 8NS

T 01305 775500
E sales@wilsontominey.co.uk
W www.wilsontominey.co.uk



****VIDEO TOUR**** Pets Considered TWO BEDROOM, GROUND FLOOR flat in Weston, Portland, moments from shops and bus route.
The property, with ALLOCATED PARKING benefits from a MODERN FITTED KITCHEN, bathroom suite, large lounge/diner and two bedrooms.

Entrance

Kitchen 10'2" x 9'10" (3.1 x 3)

Hallway

Lounge/ Diner 19'4" x 12'5" (5.9 x 3.8)

Bedroom One 9'10" x 9'6" (3 x 2.9)

Bedroom Two 9'10" x 7'2" (3 x 2.2)

Bathroom

Allocated Parking

Pet Charge

In the event a pet is considered for this property, there will be an additional charge of £25.00 per month, per pet. Please ask one of the members of our team whether a pet may be considered.

Pet Charge

In the event a pet is considered for this property, there will be an additional charge of £25.00 per month, per pet. Please ask one of the members of our team whether a pet may be considered.



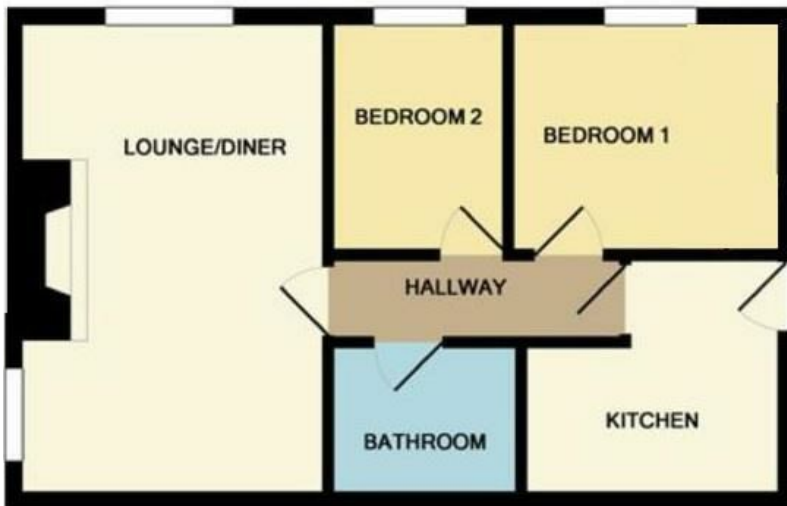

Energy Efficiency Rating		Current	Potential
Very energy efficient - lower running costs	(92 plus) A		
(81-91) B			
(69-80) C			
(55-68) D			
(39-54) E			
(21-38) F			
(1-20) G			
Not energy efficient - higher running costs			
		69	81
England & Wales	EU Directive 2002/91/EC		

Environmental Impact (CO ₂) Rating		Current	Potential
Very environmentally friendly - lower CO ₂ emissions	(92 plus) A		
(81-91) B			
(69-80) C			
(55-68) D			
(39-54) E			
(21-38) F			
(1-20) G			
Not environmentally friendly - higher CO ₂ emissions			
		64	78
England & Wales	EU Directive 2002/91/EC		